

# CAST FLANGES

## WORKING PRESSURE 10 BARS

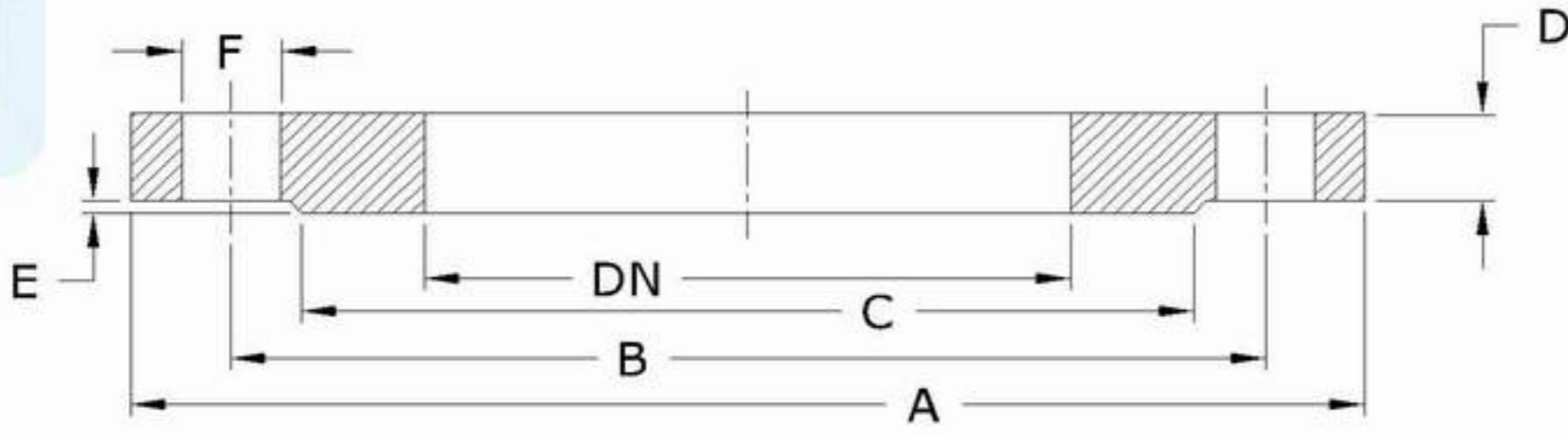

**MATERIAL : GREY CAST IRON**

DN	A	B	C	D	E	F	N
25	115	85	68	14	2	4	4
32	140	100	78	16	2	8	4
40	150	110	88	15	3	8	4
50	165	125	102	17	3	8	4
65	185	145	122	17	3	8	4
80	200	160	138	19	3	8	4
100	220	180	158	19	3	8	8
125	250	210	188	21	3	8	8
150	285	240	212	21	3	23	8
200	340	295	268	23	3	23	8
250	395	350	320	25	3	23	12
300	445	400	370	25	4	23	12
350	505	460	430	26	4	23	16
400	565	515	482	28	4	27	16
500	670	620	585	30	4	27	20
600	780	725	685	31	5	30	20
700	895	840	800	35	5	30	24
800	1015	950	905	39	5	33	24
900	1115	1050	1005	41	5	33	28
1000	1230	1160	1110	45	5	36	28
1200	1455	1380	1330	51	5	39	32

N= NUMBER OF HOLES

**MATERIAL : DUCTILE CAST IRON**

DN	A	B	C	D	E	F	N
25	115	85	68	14	2	14	4
32	140	100	78	15	2	18	4
40	150	110	84	16	3	19	4
50	165	125	99	16	3	19	4
65	185	145	118	16	3	19	4
80	200	160	132	16	3	19	4
100	220	180	156	16	3	19	8
125	250	210	184	16	3	19	8
150	285	240	211	16	3	23	8
200	340	295	266	17	3	23	8
250	400	350	319	19	3	23	12
300	455	400	370	20.5	4	23	12
350	505	460	430	20.5	4	23	16
400	565	515	480	20.5	4	28	16
500	670	620	582	22.5	4	28	20
600	780	725	682	25	5	31	20
700	895	840	794	27.5	5	31	24
800	1015	950	901	30	5	34	24
900	1115	1050	1001	32.5	5	34	28
1000	1230	1160	1112	35	5	37	28
1200	1455	1380	1328	40	5	40	32

N= NUMBER OF HOLES

ALL DIM IN MM

MATERIAL : ACCORDING TO ES. 1300 - ES 1 - ISO 1083

FLANGE CONNECTIONS ACCORDING TO ISO STANDARDS 2531

FOR FLANGES DN 80 NUMBER OF HOLES MAY BE 8 ON REQUEST



GATE VALVE  
RISING STEM



GATE VALVE  
NON RISING STEM



AIR VALVE



NON RETURN  
VALVE



SAFETY VALVE



VERTICAL  
FIRE HYDRANT

# ENGINEERING INDUSTRIES

For Casting & Machining of Metals