

# AIR VALVE SINGLE ORIFICE

## DESCRIPTION :

EIC air valves are fitted at the highest level point of a pipe line to automatically ensure the following 3 functions :

- 1- Allowing the air in the pipe line to go out while filling with water.
- 2- allowing the air to enter the pipe line if a sudden shut down of the pumps happens preventing the damage of pipes due to vacuum pressure .
- 3- getting rid of the air pockets in the pipe line that may cause pitting of the pump blades and casing

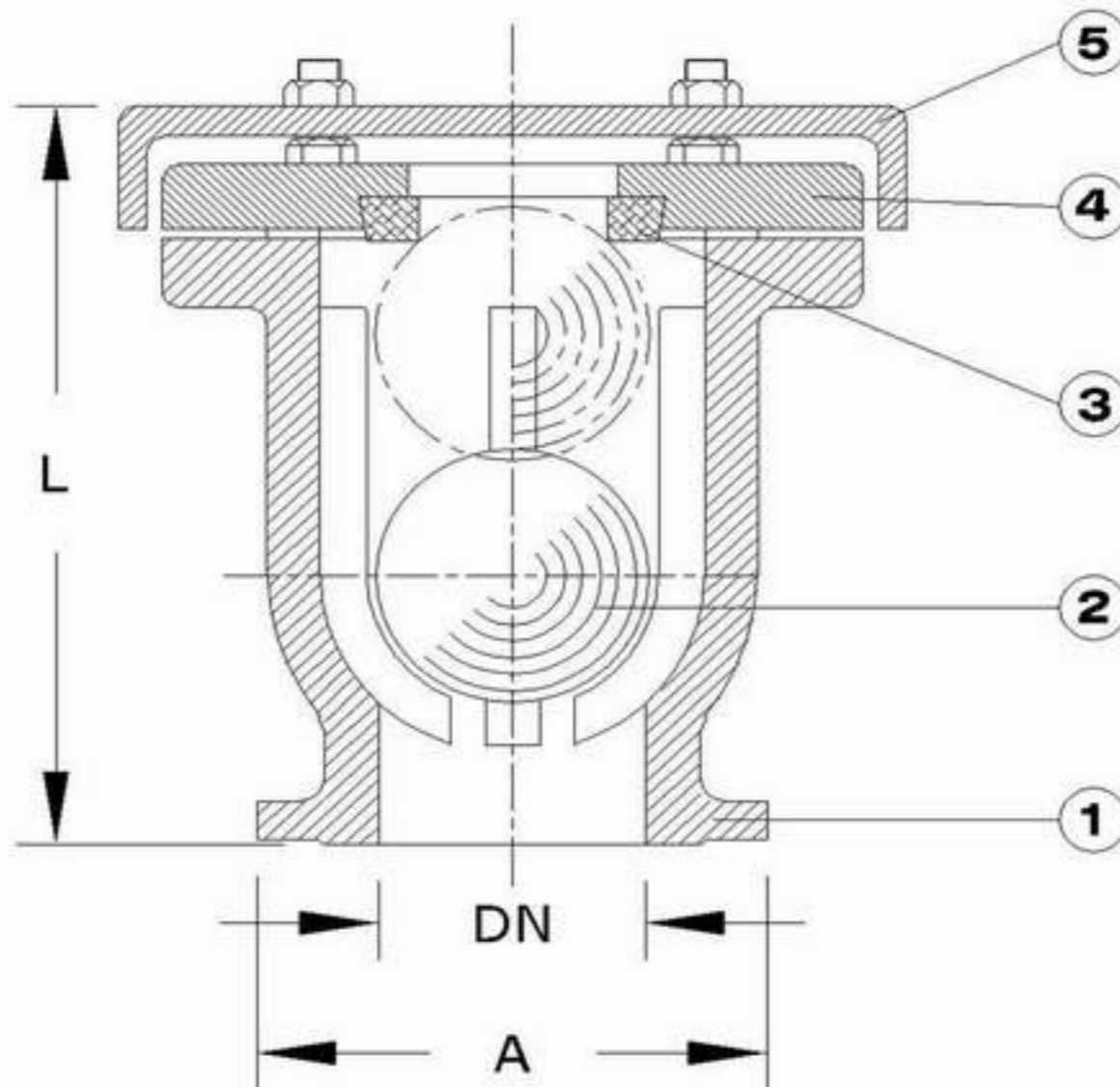

No	Description	Material	Standards
1	Body	G.C.I GG 25/D.C.I GGG 50	ES 1300 / ISO 1083
2	Balls	EPDM - NBR Rubber - ST.ST.I	BS 2494 - ASTM 304
3	Rubber Seal	EPDM - NBR	BS 2494
4	Flange	G.C.I GG 25/D.C.I GGG 50	ES 1300 / ISO 1083
5	Cover	G.C.I GG 25/D.C.I GGG 50	ES 1300 / ISO 1083

DN	A	L
50	165	265
80	200	365
100	220	365
150	285	415

WORKING PRESSURE : 10 - 16 BAR.

ALL DIM IN MM

FLANGE CONNECTIONS ACCORDING TO ISO STANDARDS 2531

VALVES CAN BE SUPPLIED IN THREADED ENDS

# ENGINEERING INDUSTRIES

For Casting & Machining of Metals



GATE VALVE  
RISING STEM



GATE VALVE  
NON RISING STEM



AIR VALVE



NON RETURN  
VALVE



SAFETY VALVE



VERTICAL  
FIRE HYDRANT